

RJ23/24/25 precision metal film resistors

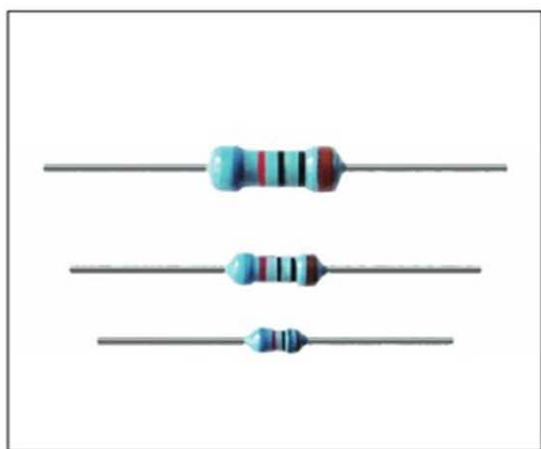

Construction (mm)

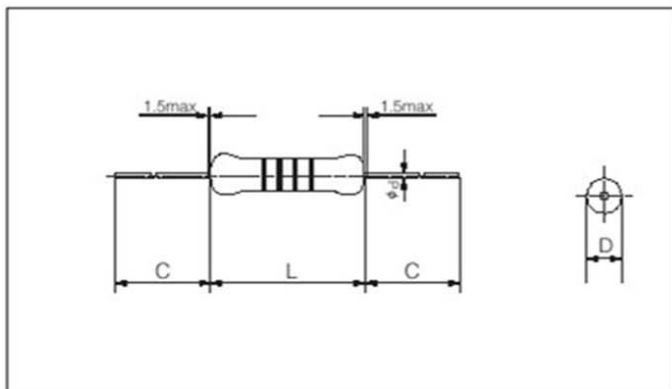

Features

- Excellent high frequency characteristic
- Long term stability
- Low noise coefficient
- Low TCR
- High precision high stability
- Blue or grey flame-retardant coating colour code marking available

Dimensions (mm)

size	Lmax	Dmax	d ± 0.05	C ± 3
RJ23	3.8	2.1	0.5	28.0
RJ24	7.0	2.5	0.6	28.0
RJ25	10.5	3.9	0.6	28.0

Applications

- Electric instruments, equipments, TV, audio and other household appliances

Derating Curve

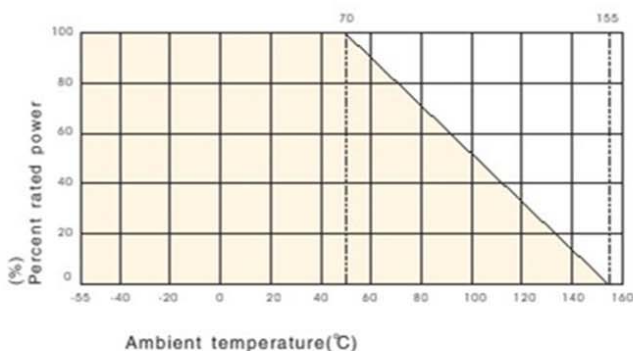

Reference Standards

- RJ23: Q/ATK 14-2003
- RJ24: Q/ATK 15-2003
- RJ25: Q/ATK 16-2003

RJ23/24/25 precision metal film resistors



Technical Specifications

Type	(W) Power Rating	Max Working Voltage(V)	Insulate Voltage (V)	Resistance Range(Ω)	TCR(ppm/ $^{\circ}$ C)	Tolerances	Rating.ambient .temp	Operating .ambient.rance
RJ23	1/6	150	250	10~240K	± 25	$\pm 0.5\%$	$\pm 70^{\circ}\text{C}$	$-55^{\circ}\text{C} \sim 155^{\circ}\text{C}$
RJ24	1/4	250	350	10~1M	± 50	$\pm 1\%$		
RJ25	1/2	350	500	10~1M				

Performance

Test Item	Specifications	Test Method
Solderability	$\geq 95\%$	$235 \pm 5^{\circ}\text{C}$, $2 \pm 0.5\text{s}$
Short time overload	$\Delta R \leq \pm (0.25\%R + 0.05\Omega)$	$2.5V_R$, 5s
Rapid change of temperature	$\Delta R \leq \pm (0.25\%R + 0.05\Omega)$	$-55^{\circ}\text{C}/155^{\circ}\text{C}$, 30min 5cycles
Leaching	$\Delta R \leq \pm (0.25\%R + 0.05\Omega)$	$350 \pm 10^{\circ}\text{C}$, $3.5 \pm 0.5\text{s}$
Climatic category	$\Delta R \leq \pm (1\%R + 0.1\Omega)$	125°C , 16h/ 55°C , RH93 $\pm 3\%$, 24h/ -55°C , 2h/ $15 \sim 35^{\circ}\text{C}$, 8.5Kpa, 1h
Endurance at 70°C	$\Delta R \leq \pm (1\%R + 0.1\Omega)$	$70 \pm 2^{\circ}\text{C}$, P_R 1000h

How To Order

Example

RJ	23	1/6	10R	$\pm 0.1\%$	$\pm 25\text{ppm}$	Plastic bags
Type	Style	Power	Nominal Value	Tolerance	TCR	Packaging
RJ	23 24 25	1/6W 1/4W 1/2W	10R	$\pm 0.5\%$ $\pm 1.0\%$	$\pm 25\text{ppm}$ $\pm 50\text{ppm}$	plastic bags tape

Packaging: Plastic recloseable bags (moq: 30pcs).